

Hex head Plug

Male thread : BSP Taper (R)

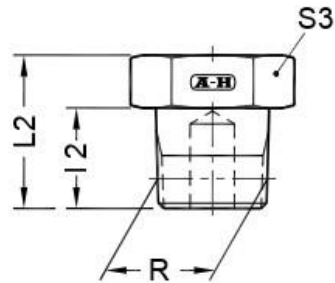

Part No.	R - Male thread BSPT	l2	L2	S3
VSTR01	R 1/8" -27	7.5	11.5	12
VSTR02	R 1/4" -18	11.0	17.0	14
VSTR03	R 3/8" -18	11.5	17.5	19
VSTR04	R 1/2" -14	15.0	25.0	22
VSTR06	R 3/4" -14	16.5	26.5	30
VSTR08	R 1" -11 1/2	19.0	31.0	36
VSTR10	R 1 1/4" -11 1/2	21.5	35.0	46
VSTR12	R 1 1/2" -11 1/2	21.5	35.0	50

Socket head Plug
Male thread : BSP Taper (R)

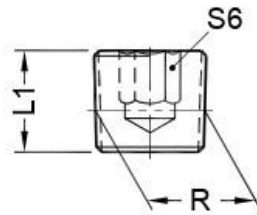

Part No.	R - Male thread BSPT	L1	S6
VSTIR01	R 1/8" -27	8.0	5
VSTIR02	R 1/4" -18	10.0	7
VSTIR03	R 3/8" -18	10.0	8
VSTIR04	R 1/2" -14	10.0	10
VSTIR06	R 3/4" -14	12.0	12
VSTIR08	R 1" -11 1/2	12.0	17
VSTIR10	R 1 1/4" -11 1/2	18.0	22
VSTIR12	R 1 1/2" -11 1/2	20.0	24

Hex head Plug

Male thread : BSPP (G) - ISO 228

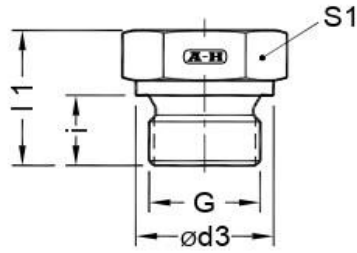

Part No.	G Male thread BSPP	ød3	i	l1	S1
VSTG01	G 1/8	14	8	14.5	14
VSTG02	G 1/4	18	12	20.0	19
VSTG03	G 3/8	22	12	22.5	22
VSTG04	G 1/2	26	14	24.0	27
VSTG06	G 3/4	32	16	26.0	32
VSTG08	G 1	39	16	27.0	41
VSTG10	G1 1/4	49	16	28.0	50
VSTG12	G1 1/2	55	16	30.0	55

Hex head Plug with Elastomeric seal

Male thread : BSPP (G) - ISO 228

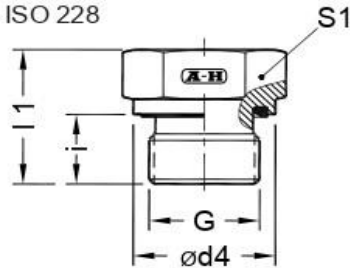

Part No.	G Male thread BSPP	ød4	i	l1	S1
VSTG01E	G 1/8	14	8	14.5	14
VSTG02E	G 1/4	19	12	20.0	19
VSTG03E	G 3/8	22	12	22.5	22
VSTG04E	G 1/2	27	14	24.0	27
VSTG06E	G 3/4	32	16	26.0	32
VSTG08E	G 1	40	16	27.0	41
VSTG10E	G1 1/4	50	16	28.0	50
VSTG12E	G1 1/2	55	16	30.0	55

Socket head Plug

Male thread : BSPP (G) - ISO 228

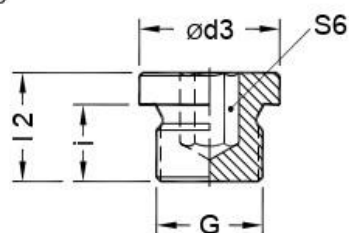

Part No.	G Male thread BSP	ød3	i	L2	S6
VSTIG01	G 1/8	14	8	11	5
VSTIG02	G 1/4	18	12	15	6
VSTIG03	G 3/8	22	12	15	8
VSTIG04	G 1/2	26	14	18	10
VSTIG06	G 3/4	32	16	20	12
VSTIG08	G 1	39	16	21	17
VSTIG10	G1 1/4	49	16	21	22
VSTIG12	G1 1/2	55	16	21	24

Socket head Plug with Elastomeric Seal

Male thread : BSPP (G) - ISO 228

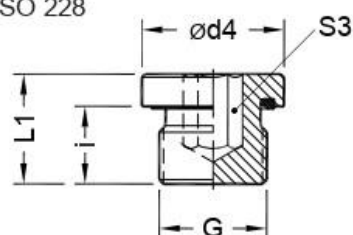

Part No.	G Male thread BSP	ød4	i	L1	S3
VSTIG01E	G 1/8	14	8	13	5
VSTIG02E	G 1/4	19	12	17	6
VSTIG03E	G 3/8	22	12	17	8
VSTIG04E	G 1/2	27	14	20	10
VSTIG06E	G 3/4	32	16	22	12
VSTIG08E	G 1	40	16	24	17
VSTIG10E	G1 1/4	50	16	24	22
VSTIG12E	G1 1/2	55	16	24	24

Socket head Plug

Male thread : Metric (M) - ISO 261

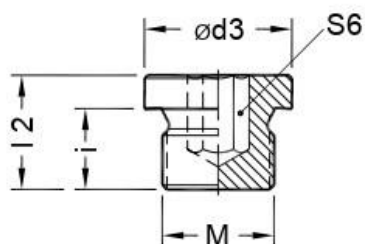

Part No.	Working Pressure (bar)	M Male thread Metric	ød3	i	l2	S6	Tightening Torque N-m
VSTIM10	400	M10 x 1.0	14	8	12.3	5	12
VSTIM12	400	M12 x 1.5	17	12	17.3	6	25
VSTIM14	400	M14 x 1.5	19	12	17.3	6	35
VSTIM16	400	M16 x 1.5	22	12	17.3	8	50
VSTIM18	400	M18 x 1.5	24	12	17.3	8	60
VSTIM20	400	M20 x 1.5	26	14	19.3	10	70
VSTIM22	400	M22 x 1.5	27	14	19.3	10	80
VSTIM26	160	M26 x 1.5	32	16	21.3	12	120
VSTIM27	400	M27 x 2.0	32	16	21.3	12	135
VSTIM33	400	M33 x 2.0	40	16	22.8	17	225
VSTIM42	250	M42 x 2.0	50	16	22.8	22	360
VSTIM48	250	M48 x 2.0	55	16	22.8	24	400

Socket head Plug with Elastomeric seal (ISO 9974-4)
 Male thread : Metric (M) - ISO 261

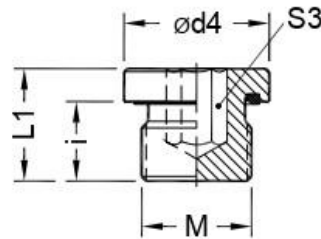

Part No.	Working Pressure (bar)	M Male thread Metric	ød4	i	L1	S3	Tightening Torque N-m
VSTIM10E	400	M10 x 1.0	14	8	12.3	5	12
VSTIM12E	400	M12 x 1.5	17	12	17.3	6	25
VSTIM14E	400	M14 x 1.5	19	12	17.3	6	35
VSTIM16E	400	M16 x 1.5	22	12	17.3	8	50
VSTIM18E	400	M18 x 1.5	24	12	17.3	8	60
VSTIM20E	400	M20 x 1.5	26	14	19.3	10	70
VSTIM22E	400	M22 x 1.5	27	14	19.3	10	80
VSTIM26E	160	M26 x 1.5	32	16	21.3	12	120
VSTIM27E	400	M27 x 2.0	32	16	21.3	12	135
VSTIM33E	400	M33 x 2.0	40	16	22.8	17	225
VSTIM42E	250	M42 x 2.0	50	16	22.8	22	360
VSTIM48E	250	M48 x 2.0	55	16	22.8	24	400

Socket head Plug with O-Ring (ISO 6149-4)
Male thread : Metric (M) - ISO 261

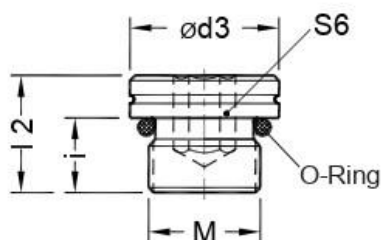

Part No.	Working Pressure (bar)	M Male thread Metric	$\varnothing d3$	i	l2	S6	O-Ring ID x CSD	Tightening Torque N-m
VSTIM100	420	M10 x 1.0	13.8	9.5	13.5	5	8.1 x 1.6	15
VSTIM120	420	M12 x 1.5	16.8	11.0	15.5	6	9.3 x 2.2	22
VSTIM140	630	M14 x 1.5	18.8	11.0	16.0	6	11.3 x 2.2	45
VSTIM160	630	M16 x 1.5	21.8	12.5	17.5	8	13.3 x 2.2	55
VSTIM180	630	M18 x 1.5	23.8	14.0	19.0	8	15.3 x 2.2	70
VSTIM220	630	M22 x 1.5	26.8	15.0	20.0	10	19.3 x 2.2	100
VSTIM260 *	400	M26 x 1.5	31.0	16.0	21.0	12	23.0 x 2.4	—
VSTIM270	400	M27 x 2.0	31.8	18.5	23.5	12	23.6 x 2.9	170
VSTIM300	400	M30 x 2.0	35.8	18.5	24.5	14	26.6 x 2.9	215
VSTIM330	400	M33 x 2.0	40.8	18.5	24.5	14	29.6 x 2.9	310
VSTIM420	250	M42 x 2.0	49.8	19.0	25.0	17	38.6 x 2.9	330
VSTIM480	250	M48 x 2.0	54.8	21.5	27.5	17	44.6 x 2.9	420
VSTIM600	250	M60 x 2.0	64.8	24.0	30.0	19	56.6 x 2.9	500

* Not included in ISO 6149-4 standard

Socket head Plug

Male thread : Metric (M) - ISO 261

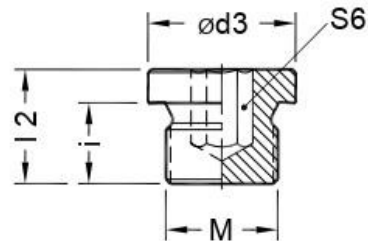

Part No.	Working Pressure (bar)	M Male thread Metric	$\varnothing d3$	i	l2	S6	Tightening Torque N-m
VSTIM10	400	M10 x 1.0	14	8	12.3	5	12
VSTIM12	400	M12 x 1.5	17	12	17.3	6	25
VSTIM14	400	M14 x 1.5	19	12	17.3	6	35
VSTIM16	400	M16 x 1.5	22	12	17.3	8	50
VSTIM18	400	M18 x 1.5	24	12	17.3	8	60
VSTIM20	400	M20 x 1.5	26	14	19.3	10	70
VSTIM22	400	M22 x 1.5	27	14	19.3	10	80
VSTIM26	160	M26 x 1.5	32	16	21.3	12	120
VSTIM27	400	M27 x 2.0	32	16	21.3	12	135
VSTIM33	400	M33 x 2.0	40	16	22.8	17	225
VSTIM42	250	M42 x 2.0	50	16	22.8	22	360
VSTIM48	250	M48 x 2.0	55	16	22.8	24	400

Hex head Plug

Male thread : NPTF (SAE J476)

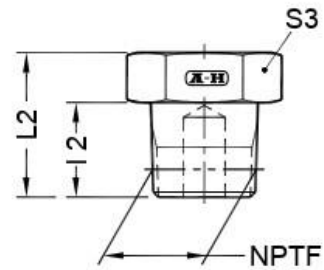

Part No.	Male thread NPTF	I 2	L2	S3
VSTN01	1/8" -27	9.7	14.5	12
VSTN02	1/4" -18	14.2	19.0	17
VSTN03	3/8" -18	14.2	19.5	19
VSTN04	1/2" -14	19.05	24.0	24
VSTN06	3/4" -14	19.05	27.0	30
VSTN08	1.0" -11 1/2	23.9	32.0	36
VSTN10	1 1/4" -11 1/2	24.6	32.5	46
VSTN12	1 1/2" -11 1/2	25.4	35.0	50
VSTN16	2.0" -11 1/2	26.2	38.0	65

Socket head Plug

Male thread : NPTF (SAE J476)

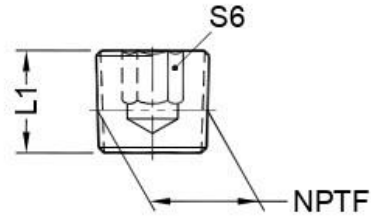

Part No.	Male thread NPTF	L1	S6
VSTIN00	1/16" -27	7.8	4
VSTIN01	1/8" -27	7.8	5
VSTIN02	1/4" -18	12.0	6
VSTIN03	3/8" -18	12.0	8
VSTIN04	1/2" -14	16.0	10
VSTIN06	3/4" -14	16.2	14
VSTIN08	1.0" -11 1/2	20.0	14
VSTIN10	1 1/4" -11 1/2	20.0	25.4
VSTIN12	1 1/2" -11 1/2	20.0	30
VSTIN16	2.0" -11 1/2	21.0	30

Hex head Plug with O-Ring
 Male thread : SAE (UNF/UN) - ISO 263

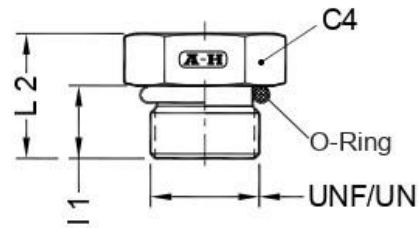

Part No.	Male thread UNF/UN	L1	L2	C4	O - Ring ID x CSD
VSTS02	5/16" -24	7.54	15.2	12	6.07 x 1.63
VSTS03	3/8" -24	7.54	15.2	12	7.65 x 1.63
VSTS04	7/16" -20	9.14	17.0	14	8.92 x 1.83
VSTS05	1/2" -20	9.14	17.0	17	10.52 x 1.83
VSTS06	9/16" -18	9.93	18.5	17	11.89 x 1.98
VSTS08	3/4" -16	11.13	20.3	22	16.36 x 2.21
VSTS10	7/8" -14	12.7	23.6	27	19.18 x 2.46
VSTS12	1.1/16" -12	15.09	27.7	32	23.47 x 2.95
VSTS14	1.3/16" -12	15.09	27.7	36	26.62 x 2.95
VSTS16	1.5/16" -12	15.09	28.4	41	29.74 x 2.95
VSTS20	1.5/8" -12	15.09	30.5	46	37.47 x 3.00
VSTS24	1.7/8" -12	15.09	32.3	55	43.69 x 3.00
VSTS32	2.1/2" -12	15.09	36.3	70	59.36 x 3.00

Socket head Plug with O-Ring

Male thread : SAE (UNF/UN) - ISO 263

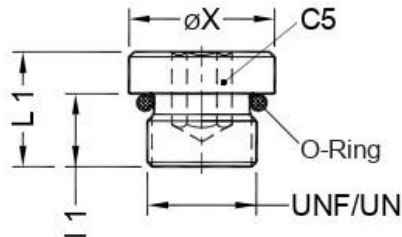

Part No.	Male thread UNF/UN	ØX	I 1	L1	C5	O - Ring ID x CSD
VSTIS02	5/16" -24	11.13	7.54	10.2	3.18	6.07 x 1.63
VSTIS03	3/8" -24	12.70	7.54	10.2	3.18	7.65 x 1.63
VSTIS04	7/16" -20	14.30	9.14	11.9	4.78	8.92 x 1.83
VSTIS05	1/2" -20	15.88	9.14	11.9	4.78	10.52 x 1.83
VSTIS06	9/16" -18	17.48	9.93	12.7	6.35	11.89 x 1.98
VSTIS08	3/4" -16	22.00	11.13	14.7	7.95	16.36 x 2.21
VSTIS10	7/8" -14	25.40	12.7	16.5	9.52	19.18 x 2.46
VSTIS12	1.1/16" -12	31.75	15.09	19.5	14.3	23.47 x 2.95
VSTIS14	1.3/16" -12	34.92	15.09	19.5	14.3	26.62 x 2.95
VSTIS16	1.5/16" -12	38.10	15.09	19.5	15.88	29.74 x 2.95
VSTIS20	1.5/8" -12	47.62	15.09	19.5	19.05	37.47 x 3.00
VSTIS24	1.7/8" -12	53.98	15.09	19.5	19.05	43.69 x 3.00
VSTIS32	2.1/2" -12	69.85	15.09	19.5	19.05	59.36 x 3.00